

TFT LCD Monitor

15.0" TFT Color LCD Monitor
15.0" TFT Color LCD Touch Monitor

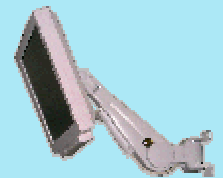

Model Selection

- MT1500** 15 Pin D-Sub VGA PC graphic
- MT1500A** MT1500 With Audio Stereo Speaker
- MT1500AV** MT1500A with Video Composite and S-video Input
- MT1500AVU** MT1500AV with USB
- MT1500/Tx** Optional Touch Screen
MT1500/TC for Capacitive
MT1500/TR for Resistive

Main Features

- ★ High Quality Image
- ★ Build-in Stereo Speaker
- ★ PAL/NTSC/SECAM Video Input
- ★ USB function
- ★ User Friendly OSD
- ★ Wall, Free-arm Mountable

MT1500AVU MT1500/TC MT1500/TR

■ Specifications

Model		MT1500AVU	
LCD	Screen Size	15.0" (38.1 cm) Diagonal.	
	Panel Type	TFT active matrix	
	Number of Pixel	1024 x 768(XGA)	
	Pixel Pitch	0.297mm x 0.297mm	
	Display Area (W x H)	12.0" x 9.0" (304.1 x 228.1 mm)	
	Colors	256K	
	Brightness	200cd/m ² (Typ.)	
	Contrast	300:1(Typ.)	
Input Signals	Response Time	10ms	
	Video Signal	RGB Analog, 0.714 Vp-p, 75Ω	
	Synchronization	VGA,SVGA,XGA, NTSC/PAL/SECAM	
	Horizontal Frequency	25 ~ 68 KHz,	
	Vertical Frequency	56.0 ~ 85 Hz	
Connector	Video Signal	15-pin D-SUB	
	NTSC/PAL Video-in	RCA Connector x 2; S-Video connector x 1	
	NTSC/PAL Video-out	RCA Connector x 1	
	USB	Up stream Port x 1; Down stream x 4	
Audio	Line in	Stereo (Mini Jack x 1)	
	Line out	Stereo (Mini Jack x 1)	
	Speaker	Stereo (3Watt x 2)	
External Control	Switch	Power Switch, Choice of Input Ports,	
	On-Screen Display	Brightness, Contrast, Color Control(R/G/B), Audio Control, Phase, Horizontal Size, Horizontal Position, Vertical Position, Auto Adjustment, Expansion, Recall, Reset, OSD Language (English, Japanese)	
Touch Panel (Optional)	Type	Resistive	Capacitive
	Electrical Resolution	4096 x 4096	1024 x 1024
	Response Time	15 ms	15 ms
	Communication System	Serial RS232	Serial RS232
	Durability	Over 10 million times	Over 20 million times
	Accuracy	Deviation< 2.03mm	< ±1% error
Environment	Temperature	Operating: 5°C to +50°C Storage: -20°C to +60°C	
	Humidity	Max. 95%RH (Non Condensing)	
Power Supply		Input AC100-240V 50/60 Hz, Output: DC 12V	
Power Consumption		36W(Max.) Stand by: 4W (Max.)	
Power Management		VESA DPMS	
Physical	Dimensions (W x H x D)	14.9" x 145.6" x 5.9" (380x370x153mm)	
	Weight	19.84 Lbs. (9 kg)	
Plug & Play		DDC2B (VESA Standard)	
Other Features		Auto Display Adjustment, OSD Menu Position	
Accessories		AC Adapter & Cord, RGB Cable, Audio Cable, Video Cable, Operating Manual	
Options		Touch Screen, USB Hub, Speakers, NTSC/PAL	
Limited Warranty		One Year on Parts and Labor	

- Features and Specifications are subject to change without prior notice.